

Composite dry sliding bushings, metric dimensions

Principal dimensions			Basic load ratings		Mass	Designation
d	D	B	dynamic C	static C0	kg	-
mm	14	10	kN			
<b>12</b>			14,3	30	0,0023	PCM 121410 M

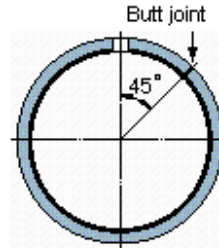
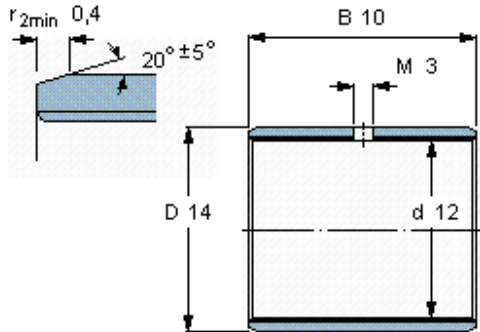

**Specific load factor** K 120  
**Material constant**  $K_M$  1900